



**SUNPOWER TECHNOLOGY CORP.**  
 33485 WESTERN AVE. UNION CITY, CA 94587, UNITED STATES  
 TEL: 510.489.5088 FAX: 510.489.8966  
 http://www.sunpower-usa.com  
 E-mail: sales@sunpower-usa.com

# SDL Series

**45W / 55W, Dual Output**  
**DC-DC Power Supply**  
**For LCD Panel PC**



177 x 50.8 x 37 mm  
 6.97 x 2.00 x 1.46 inch



### Features:

Light weight, compact size
High efficiency, high reliability
DC soft start function, low inrush current
DC input over voltage and under voltage protection
DC input polarity reverse protection
Over load, over voltage & short circuit protection
100% 50 burn-in test
UL, cUL certified
2 years warranty

### Specification:

INPUT	Voltage	SDL-045AD1: DC 9.5V~18V; SDL-055BD1: DC 18V~36V; SDL-055CD1: DC 36V~72V					
	Current	SDL-045AD1: <7A@9.5V; SDL-055BD1: <4.6A@18V; SDL-055CD1: 2.2A@36V					
OUTPUT	Voltage	SDL-045AD1		SDL-055BD1		SDL-055CD1	
		V1/+5V	V2/+12V	V1/+5V	V2/+12V	V1/+5V	V2/+12V
	Min. Load	0.1A	0A	0.1A	0A	0.1A	0A
	Max. Load	8A	1.5A	8A	1.5A	8A	1.5A
	Regulation	±5%					
	Ripple Noise (max)	50mV	120mV	50mV	120mV	50mV	120mV
	Efficiency (min.)	70%					
PROTECTION	Max Power	45W			55W		
	Over Voltage Protection	+5.8V~+7.0V	+13.8V~+17.5V	+5.8V~+7.0V	+13.8V~+17.5V	+5.8V~+7.0V	+13.8V~+17.5V
	Over Load Protection	When output power over 115% ~ 180% of rating, power supply will shut down .					
	Short Circuit Protection	Shutdown					
	Input Protection	Under voltage protection: SDL-045AD1: <8.5V, SDL-055BD1: <17V, SDL-055CD1: <34V, shut down.					
OTHERS	Rise time	<20mS					
	Cooling	Natural cooling					
Environment	Temperature	Operating: 0~70 ; derating: 45 ~70 : 2.5%/ . Storage: -10~+75					
	Humidity	Operating: 20% ~ 85%; Storage: 10% ~ 95% (non condensing)					
M.T.B.F.		SDL-045AD1: 376K hours; SDL-055BD1: 386K hours; SDL-055CD1: 397K hours					
SAFETY		UL 60950, CSA C22.2 No.60950: certified; TUV EN 60950, IEC 60950, EMKO-TSE (74-SEC)207/94: standard					
EMC	EMI	FCC CFR 47 PART 15 CLASS B, EN 50081-1, CNS 13438 CALSS B.					
	EMS	EN 50082-1 (1997)					

### Dimension:

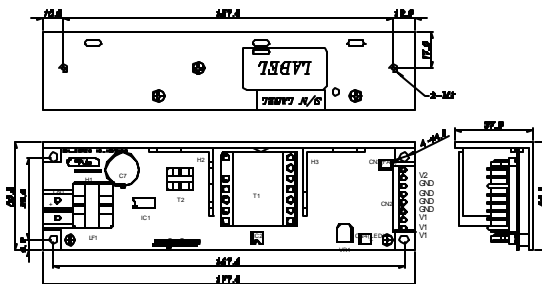

Connector: Input: 2p/ 8.25mm pitch  
 output: Molex 5273-08 or equivalent